



Innovative Photonic Solutions

Lightguides

Point Source Illumination

Illumination Technologies provides top quality flexible lightguides and “stay-put” goosenecks. Stainless steel ferrules are swaged to all of our lightguides to ensure rugged industrial reliability.

KEY FEATURES

- Structured Lighting
- High Intensity Output
- Multiple Points Sources

APPLICATIONS

- Machine Vision
- Semiconductors
- Electronics
- Printed Circuit Boards
- Surface Mount Components
- Leadframes
- Scribed, Indented and embossed feature enhancement



Lenses can increase intensity and lengthen the working distance of a lightguide without requiring a change to the lightsource settings. Below is a chart showing a typical example of these benefits for a 9230 30” lightguide with a 9510 focusing lens powered by a 3900 at full intensity.

Spot Size

Working Distance (mm)	No Lens (mm)	Lens (mm)
25	14	8
50	41	18
75	57	28
100	80	41
125	94	52
150	120	63

Intensity

Working Distance (mm)	No Lens (mW/cm ²)	Lens (mW/cm ²)
25	53.9	140.6
50	19.6	55.7
75	9.8	27.4
100	6.1	17.0
125	4.4	12.0
150	3.5	8.8

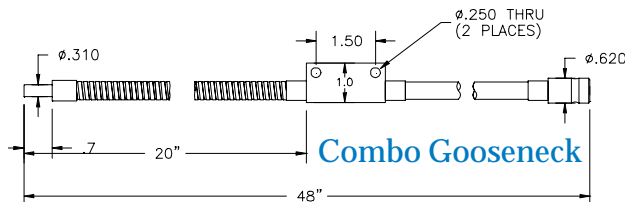
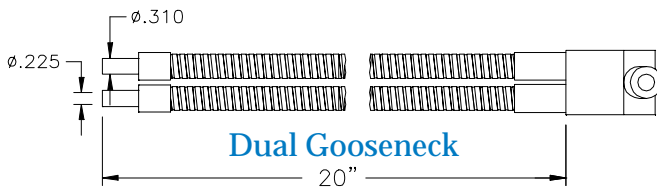
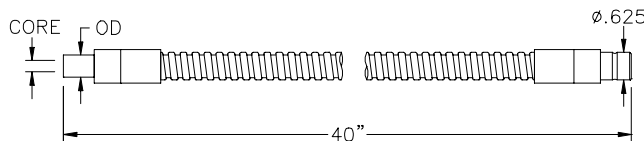
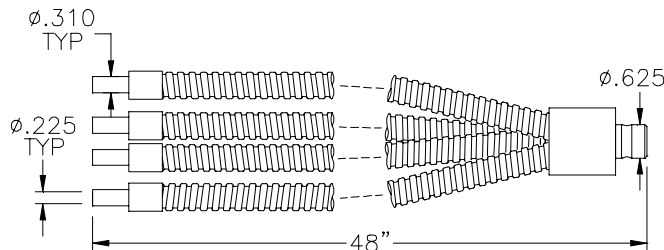
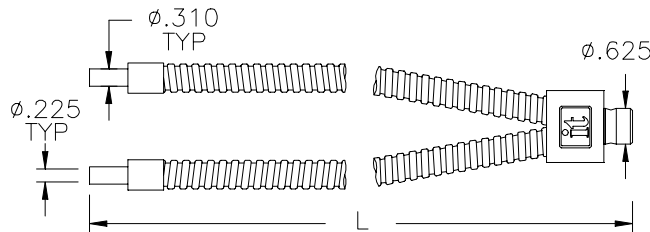
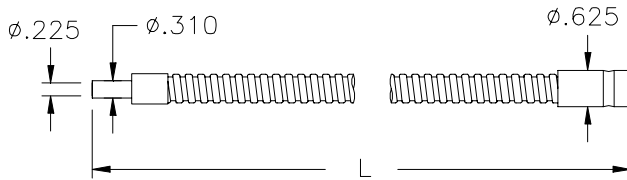

Lightguides

Rugged, flexible stainless steel sheaths provide maximum protection for industrial applications. Two standard lengths. Focusing Lens and Polarizer attachments available (see Accessories).

	Length (inches)
P/N 9230	30
P/N 9250	60

Dual Lightguides

Similar construction to the single lightguides. Dual configuration for increased intensity from both sides to help eliminate shadows. Two standard lengths.

	Length (inches)
P/N 9240	30
P/N 9260	60

Quad Lightguide

Similar construction to the single and dual lightguides. Four legged configuration for increased intensity from multiple sides.

P/N 9270

Liquid Lightguides

Twice the intensity of standard glass fiber optics with high blue transmission. Rugged, flexible stainless steel sheaths provide maximum protection for these liquid lightguides. Two standard core sizes. Also available in UV transmitting core.

	Core	OD
P/N 9280	.250	.312
P/N 9285	.375	.500

Goosenecks

Goosenecks are similar to the standard lightguide with "Stay-Put" legs which hold their position. Used primarily for quick prototyping and for manual inspection tasks. Rugged, semi-rigid chrome plated steel gooseneck sheaths with swaged SS ferrules. Three version are available.

	Configuration	Length (inches)
P/N 9310	Single	30
P/N 9320	Dual	20
P/N 9340	Combo	48

Proudly Distributed By:



Illumination Technologies, Inc.

5 Adler Drive 1 East Syracuse 1 New York 13057 USA
 TEL: 315-463-4673 1 FAX: 315-463-1401 1 Toll Free (North America): 800-738-4297
 Web: <http://www.illuminationtech.com> 1 E-mail: info@illuminationtech.com